

SCALE 1"=20'

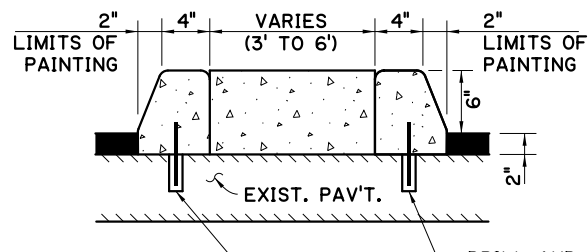

SECTION A-A
(N.T.S.)

DRILL AND GROUT #4 "U" BARS 4" INTO EXISTING PAVEMENT AT 24" O.C. SEE STANDARD PLAN CP-01 FOR DETAILS.

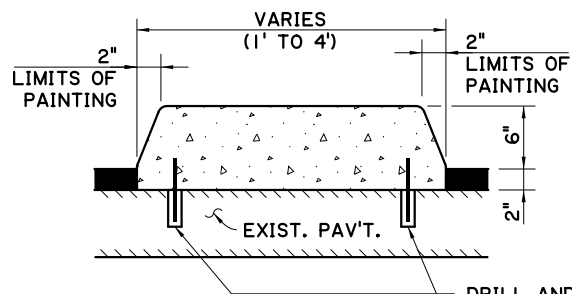

SECTION B-B
(N.T.S.)

DRILL AND GROUT #4 "U" BARS 4" INTO EXISTING PAVEMENT AT 24" O.C. SEE STANDARD PLAN CP-01 FOR DETAILS.

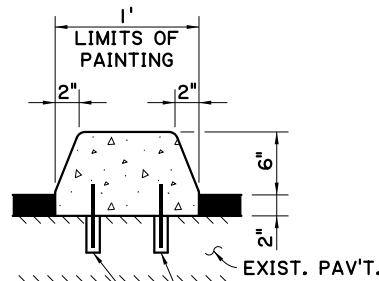

SECTION C-C
(N.T.S.)

DRILL AND GROUT #4 "U" BARS 4" INTO EXISTING PAVEMENT AT 24" O.C. SEE STANDARD PLAN CP-01 FOR DETAILS.

PRELIMINARY
NOT TO BE USED FOR CONSTRUCTION, BIDDING, RECORDATION, CONVEYANCE, SALES OR AS THE BASIS FOR THE ISSUANCE OF A PERMIT.

Louisiana Department of Transportation and Development

ENGINEER: CINDY M. HALL
LICENSE #: 27073
DATE: 01-MAY-2017

SHEET NUMBER		20	
EAST BATON ROUGE		077-05 & 000-17	
DESIGNED	RAN	CONTROL	STATE
CHECKED	CHECKED	SECTION	PROJECT
CMH	CMH	CMH	CMH
SERIES NUMBER		17 OF 49	
REVISION OR CHANGE ORDER DESCRIPTION		BY	
NO.		DATE	
LA 73 (GOVT ST) EAST BLVD - LOBDELL AVE		PLAN SHEET	
GOVERNMENT ST.		GOVERNMENT ST.	
LA 73 (GOVT ST) EAST BLVD - LOBDELL AVE		GOVERNMENT ST.	
DOTD		Stantec	

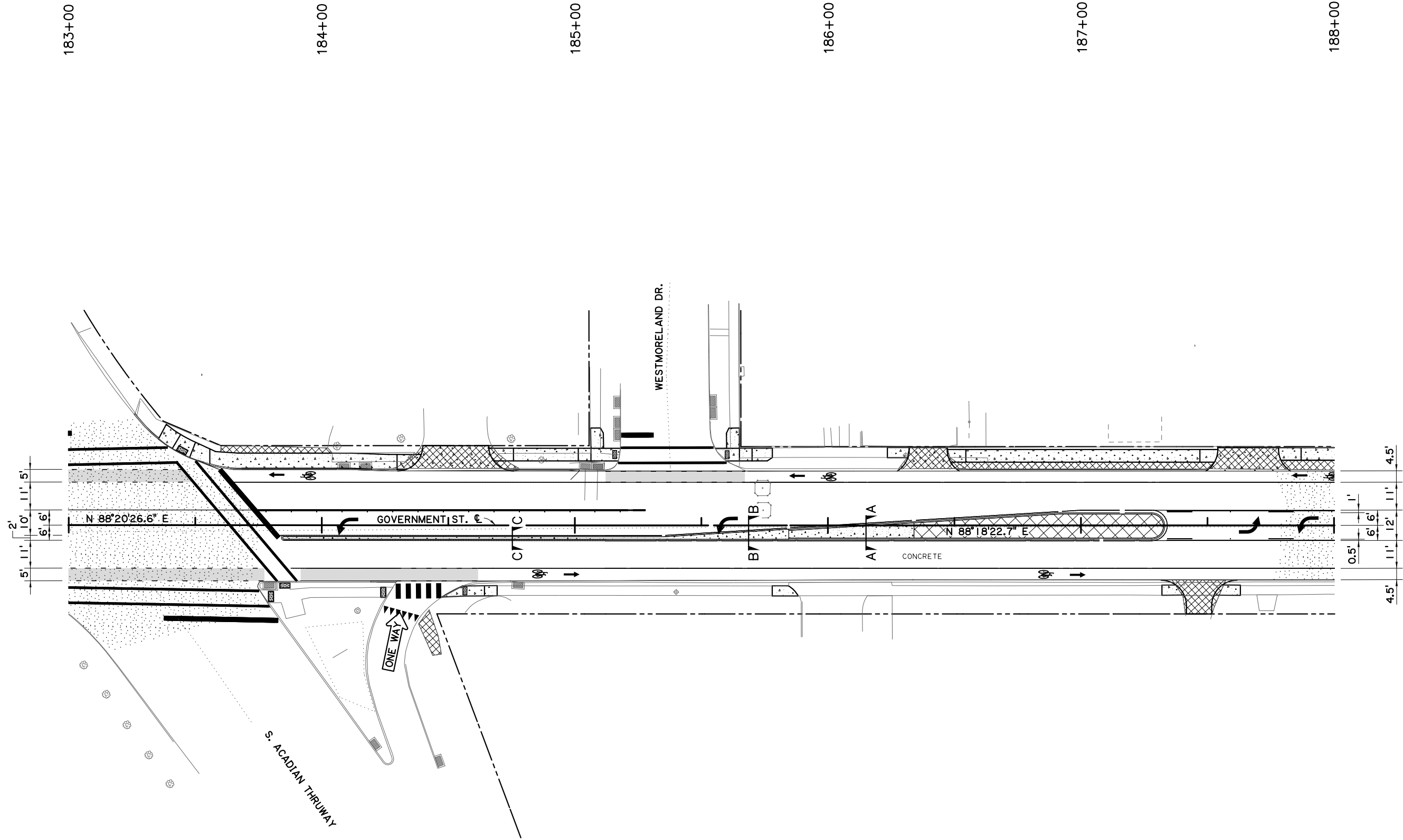

SCALE: 1"=20'

95% FINAL PLANS

PRELIMINARY
 NOT TO BE USED FOR
 CONSTRUCTION,
 BIDDING,
 RECORDATION,
 CONVEYANCE, SALES
 OR AS THE BASIS FOR
 THE ISSUANCE OF A
 PERMIT.

**Louisiana Department
 of Transportation
 and Development**

ENGINEER: CINDY M. HALL
 LICENSE #: 27073
 DATE: 01-MAY-2017

DOTD	Stantec	<p>PLAN SHEET</p> <p>GOVERNMENT ST.</p> <p>LA 73 (GOVT ST) EAST BLVD - LOBDELL AVE</p>		<p>DESIGNED CHECKED CMH</p> <p>DETAILED CHECKED CMH</p> <p>SERIES NUMBER 18 OF 49</p>	<p>PARISH CONTROL SECTION STATE PROJECT</p> <p>EAST BATON ROUGE 077-05 & 000-17 H.O.11295</p>	<p>SHEET NUMBER 21</p>	
<p>REVISION OR CHANGE ORDER DESCRIPTION</p>				<p>NO. DATE</p>		<p>BY</p>	