

95% FINAL PLANS

F:\Projects\201802354.05\03 disciplines\highway\plan\_development\drawings\working\public\_letters-divider\_islands\0013\_pp.dgn 02-MAY-2017 10:38

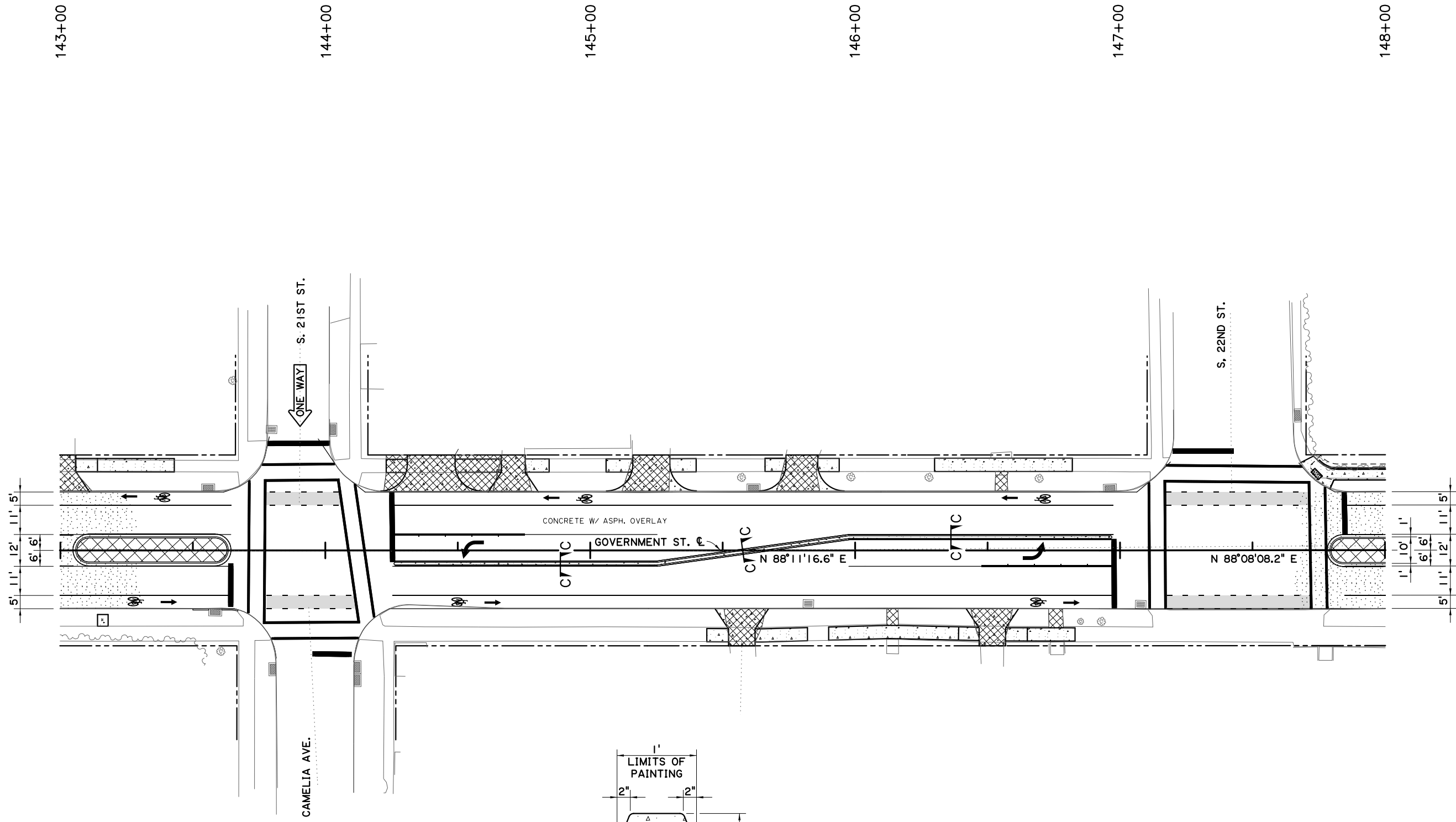

SCALE: 1"=20'

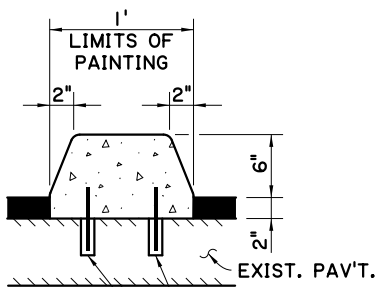

DRILL AND GROUT #4 "U" BARS 4" INTO EXISTING PAVEMENT AT 24" O.C. SEE STANDARD PLAN CP-01 FOR DETAILS.

SECTION C-C (N.T.S.)

95% FINAL PLANS

<p><b>PRELIMINARY</b> NOT TO BE USED FOR CONSTRUCTION, BIDDING, RECORDATION, CONVEYANCE, SALES OR AS THE BASIS FOR THE ISSUANCE OF A PERMIT.</p>	<p style="text-align: center;"><b>Louisiana Department of Transportation and Development</b></p> <p>ENGINEER: CINDY M. HALL LICENSE #: 27073 DATE: 02-MAY-2017</p>
--	--

SHEET NUMBER	EAST BATON ROUGE	PARISH	CONTROL SECTION	STATE PROJECT	SHEET NUMBER	3
DESIGNED	RAN	CHECKED	CMH	KXH	077-05 & 000-17	H.O. 1295
SERIES NUMBER	10 OF 49	BY				
NO.	DATE	REVISION OR CHANGE ORDER DESCRIPTION				BY
<p>PLAN SHEET</p> <p>GOVERNMENT ST.</p> <p>LA 73 (GOVT ST) EAST BLVD - LOBDELL AVE</p>						